

Size: Ø225.0mmx99mm
Airflow: 416~792CFM
Weight: 2.0~2.6kg
Noise: 56~75dBA
Impeller: Plastic PA6.6 (polyamide glass-fibre reinforced)
 Injection-moulded round sheet-metal plate or plastic plate
Motor: Capacitor-Run Induction and external rotor Motor
Rotor: Black paint
Lead Wire: AWG#20 UL2450
Insulation: Class B, Thermally protected
Safety: UL.CUL.TUV.CE
Operation Temperature: -10°C~+65°C

Unit:mm

Model	Bearing System	Voltage VAC	Freq. Hz	Current A	Power W	Speed RPM	Noise dBA	Capacitor uf	Air Flow CFM	Static Pressure (mmH ₂ O)
REH225x90-1CN	Ball	230	50/60	0.61/0.76	145/185	2650/3000	72/75	6.0	716/792	53/73
REM225x90-1CN		230	50/60	0.49/0.71	120/165	2550/2750	70/73	4.5	700/748	52/68
REL225x90-1CN		230	50/60	0.23/0.34	35/35	1400/1600	56/61	1.0	416/470	14.5/21.0
REH225x90-2CN		115	60	1.56	196	3000	75	18.0	792	73
REM225x90-2CN		115	60	1.5	165	2750	73	18.0	748	68
REL225x90-2CN		115	60	0.50	35	1600	61	3.0	470	21.0

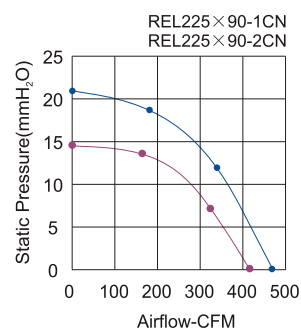
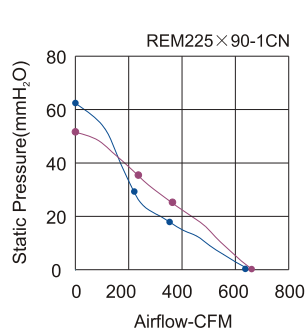
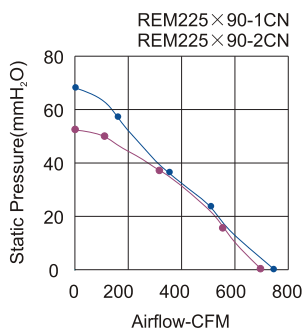
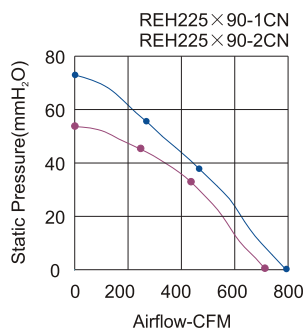
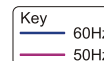

AC RE252X84 SERIES MOTORIZED IMPELLER

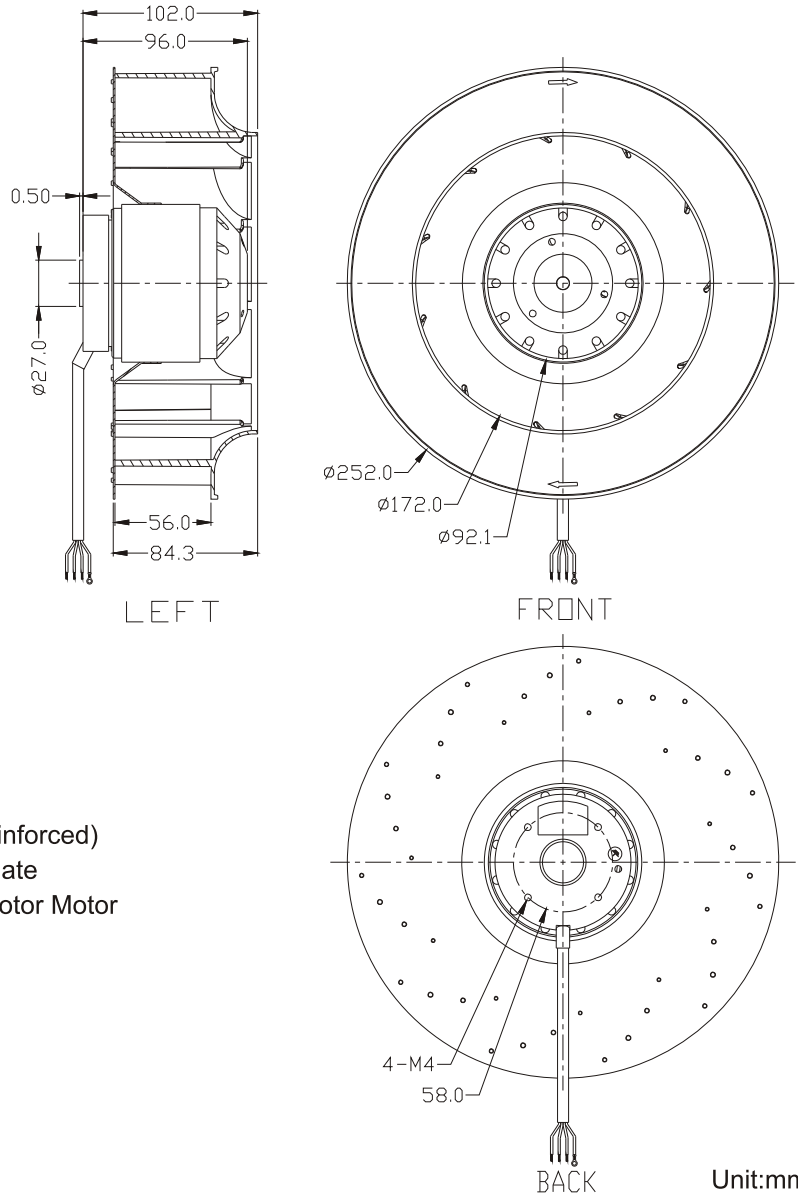

Size: Ø252.0mmx102.0mm
Airflow: 495~921CFM
Weight: 2.0~3.5kg
Noise: 59~73dBA
Impeller: Plastic PA6.6 (polyamide glass-fibre reinforced)
 Injection-moulded round sheet-metal plate
Motor: Capacitor-Run Induction and external rotor Motor
Rotor: Black paint
Lead Wire: AWG#20 UL2450
Insulation: Class B, Thermally protected
Safety: UL.CUL.TUV.CE
Operation Temperature: -10°C~+65°C

Unit:mm

Model	Bearing System	Voltage VAC	Freq. Hz	Current A	Power W	Speed RPM	Noise dBA	Capacitor uf	Air Flow CFM	Static Pressure (mmH ₂ O)
REH252x84-1CN	Ball	230	50/60	0.87/1.1	200/273	2650/2950	73/76	6.0	830/921	73/98
REM252x84-1CN		230	50/60	0.71/1.0	170/230	2600/2750	73/74	5.0	785/840	71.7/92
REL252x84-1CN		230	50/60	0.30/0.38	48/52	1400/1650	59/62	1.5	495/573	20/28.5
REH252x84-2CN		115	60	2.2	273	2950	76	22.0	921	98
REM252x84-2CN		115	60	1.9	240	2550	74	18.0	779	86
REL252x84-2CN		115	60	0.53	52	1650	62	5.0	573	28.5

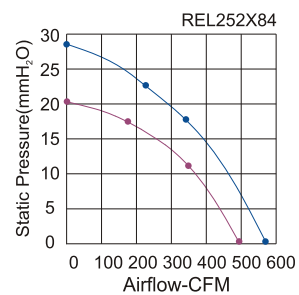
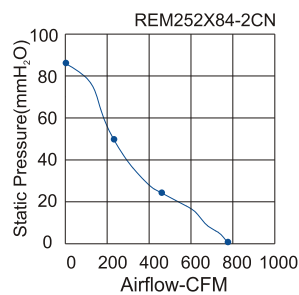
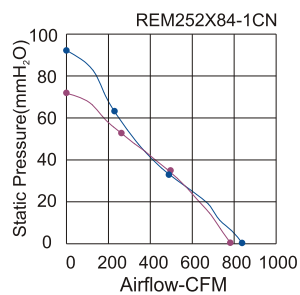
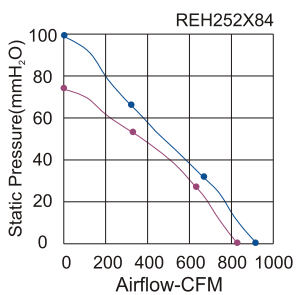

Key
 — 60Hz
 — 50Hz